



Residence 101

1 Bed 1 Bath



Level	1
View	Street
Internal	38.33m2 / 412sqf
External	5.59m2 / 60sqf
Total	43.92m2 / 472sqf

- Cozy and functional one-bedroom apartment.
- Open-plan living and kitchen area.
- Outdoor balcony.
- The bedroom is spacious enough to fit a king-size bed.
- Walk-in closet.
- Full bathroom with guest access and laundry area.
- SMEG & SAMSUNG appliances.

Please note that this floor plan is a guide only and was prepared prior to completion of the development. The information contained in this floor plan is believed to be correct at the time of preparation but is not guaranteed. Changes may be made during developmet and the floor plan is subject to change without notice at any time in accordance with the provisions of the Contract.

Ki Residences, Playa del Carmen

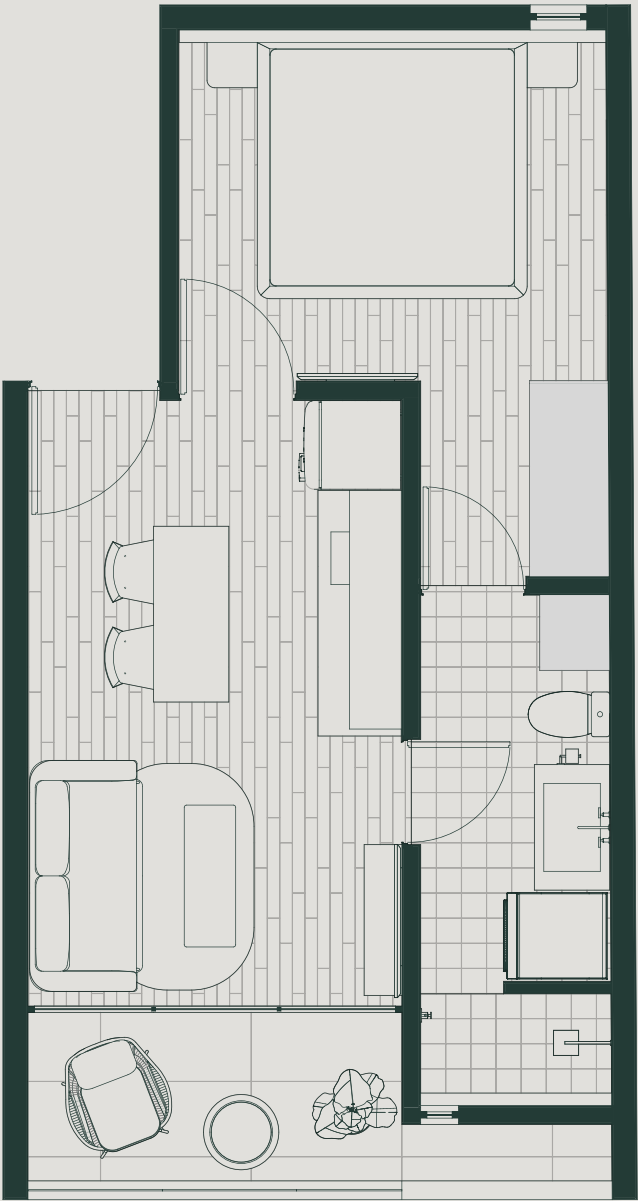



Kitchen area



Balcony



Kitchen area



Bedroom



Bedroom



Bedroom



Balcony



Lounge area



Bedroom