

# MAIA

PLAYA DEL CARMEN

## Ocean View Condos

An exceptional living experience in the Riviera Maya

### Suite

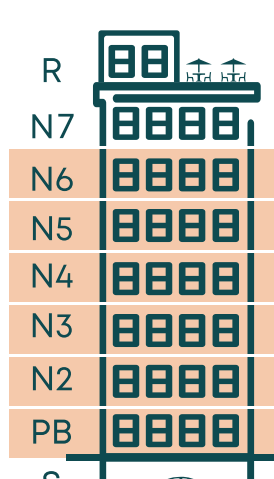

Interior 237 sqft

Exterior -

TOTAL 237 sqft

SMX 1,766,000

### Studios

#### "A"

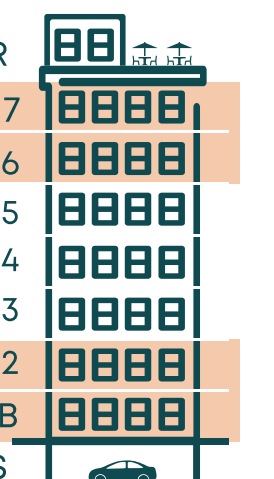

Interior 377 sqft

Exterior 43 sqft

TOTAL 420 sqft

prices starting at SMX 3,050,000

#### "B"

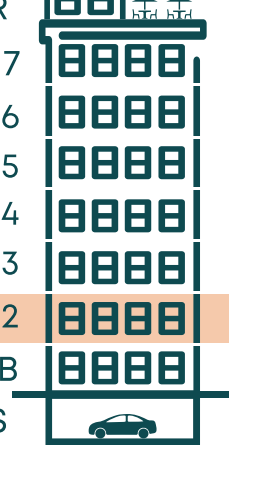

Interior 360 sqft

Exterior 27 sqft

TOTAL 387 sqft

prices starting at SMX 2,720,500

### 1 Bedroom

#### "A"

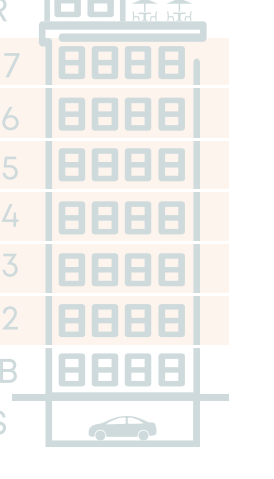

Interior 496 sqft

Exterior 64 sqft

TOTAL 560 sqft

prices starting at SMX 3,660,000

#### "B"

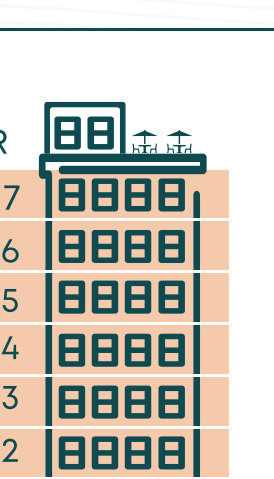

Interior 517 sqft

Exterior 43 sqft

TOTAL 560 sqft

#### "C"



Interior 377 sqft

Exterior 86 sqft

TOTAL 463 sqft

prices starting at SMX 3,350,000

### 2 Bedrooms

#### "LOCK OFF" System

Enjoy your private space while increasing your income renting other sections of your apartment.

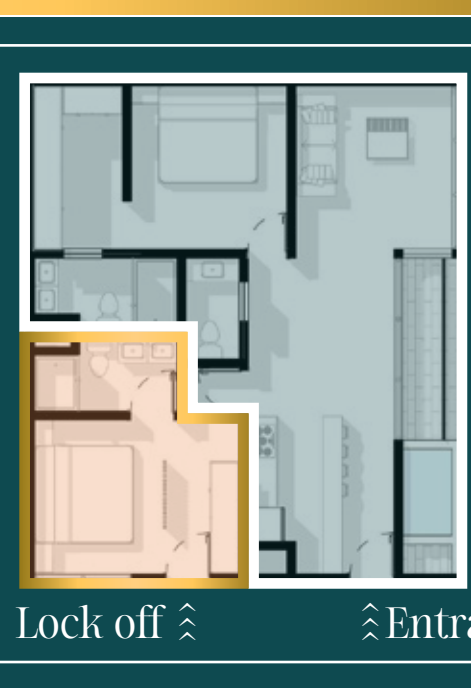

#### "A"

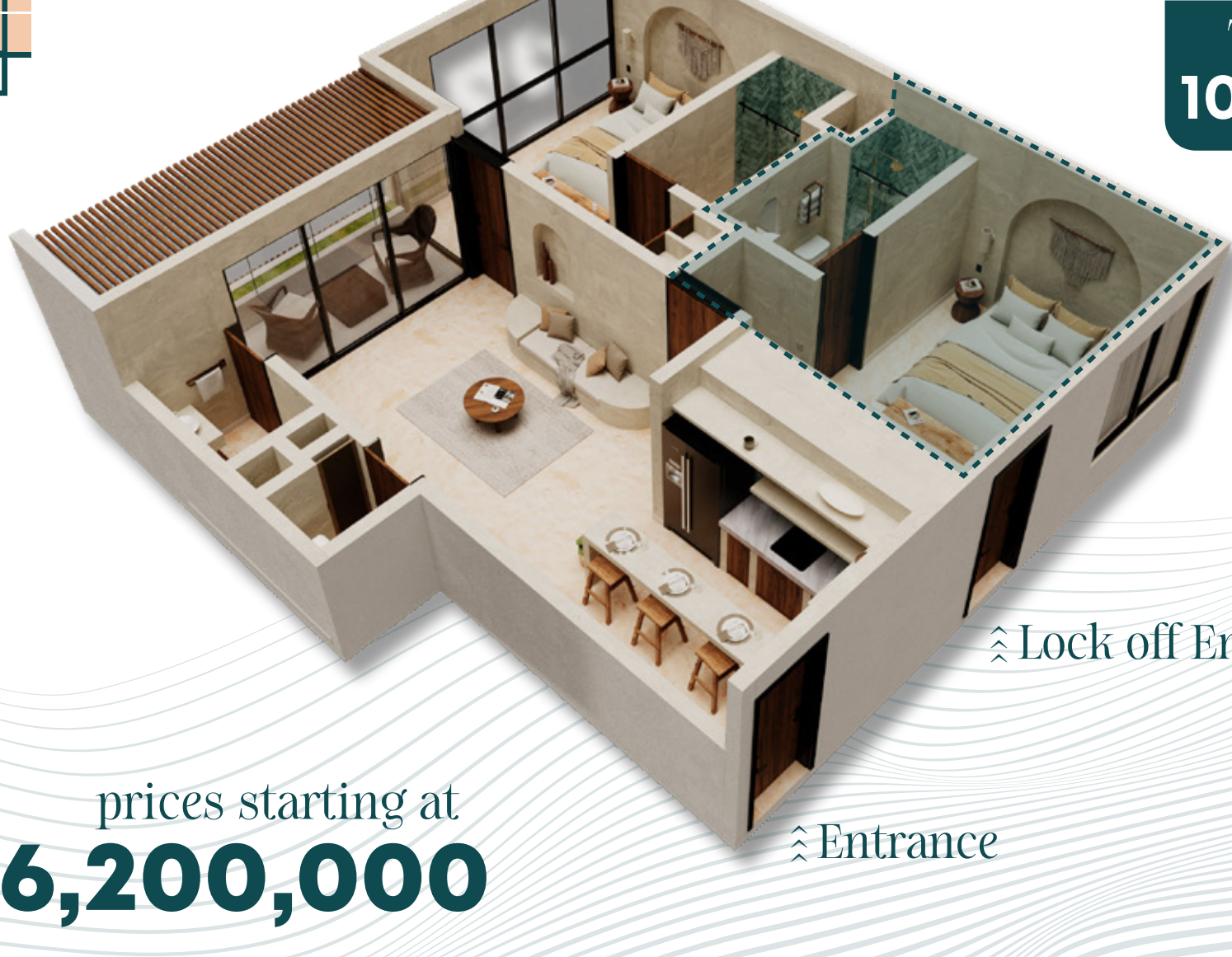
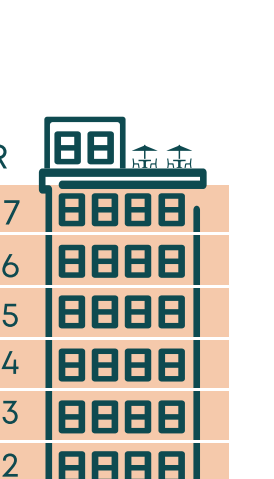

Interior 926 sqft

Exterior 86 sqft

TOTAL 1012 sqft

prices starting at SMX 6,200,000

#### "B"

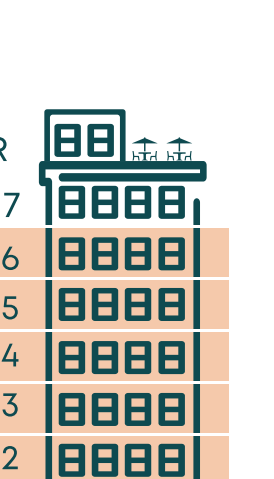

Interior 689sqft

Exterior 86 sqft

TOTAL 775 sqft

SMX 4,500,000

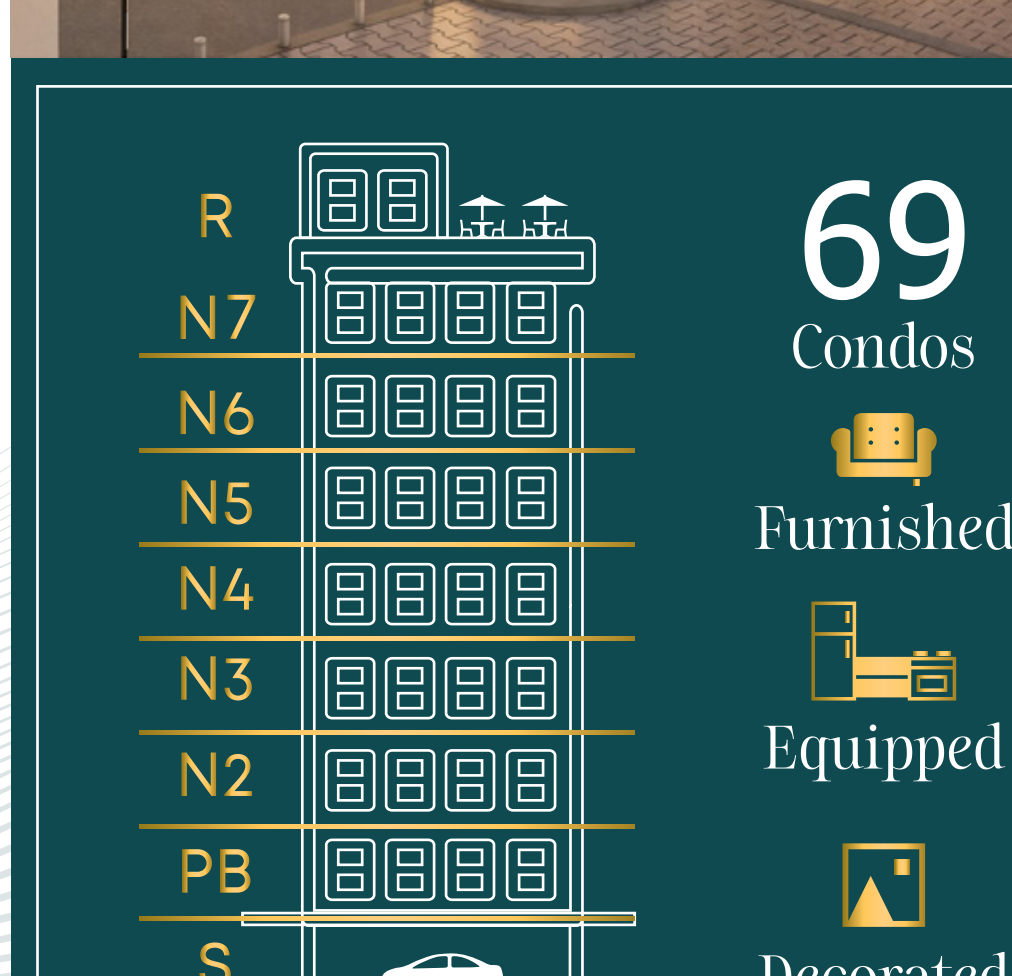

69 Condos

Furnished

Equipped

Decorated

[Land 6458 sqft]

### PRICES RANGE

\$mX 1,766,000

\$mX 6,200,000

### LOCATION

Quinta Avenida & Calle 104 Norte



### AMENITIES

- Sky Bar
- Yoga Area
- Lounge Chairs
- Restaurante
- Sala Lounge
- BiciParking
- Infinity Pool
- Underground Parking

### SERVICES

- Platform Requirements
- Ice Machine
- Reception
- Elevator
- Security
- Wi Fi
- Cleaning
- General Maint.
- CCTV
- Laundry Area



Welcome to Maia

\*\* illustrative images